

# **HULTDINS** Chain grease Pump

---

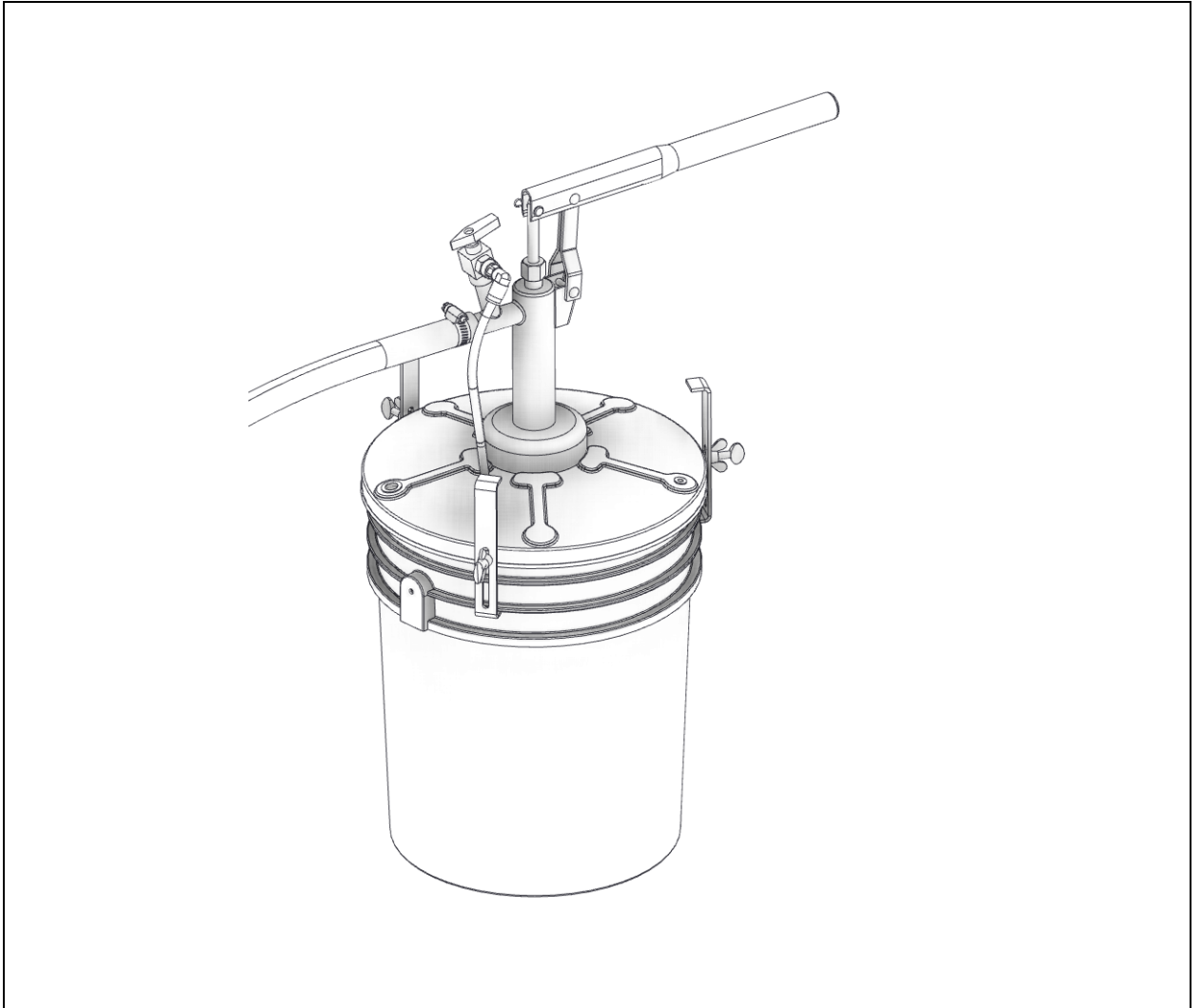

**Transferpump**

---

Installation- and user's manual

This publication contains instructions for the installation and maintenance of the Hultdins transferpump. If doubt should arise concerning the validity of the instructions please consult Hultdins for more detailed information.

Illustrations, technical information and specifications were, as far as we have been able to judge, correct at the time of print. However, we reserve the right to, without prior notice, revise specifications, instructions, equipment, etc. as a result of ongoing product improvement activities.

No part of this publication may without approval of HULTDIN SYSTEM AB be translated, reproduced, stored or transmitted electronically, mechanically, photographically or in another way not specified here.

Even if all conceivable measures have been taken to make the contents as complete as possible, HULTDIN SYSTEM AB takes no responsibility for possible damages that may arise as a result of the instructions not being followed or improper use of the product



**Caution!**

The parts and components used in HULTDIN SYSTEM AB's products are specifically chosen. Therefore original spare parts are always the best alternative in a possible need of repairs or upgrading.

All service and repairs should be performed by qualified personnel only.

This publication is a translation from the Swedish original.

This publication is released by: HULTDIN SYSTEM AB  
Skolgatan 12  
SE-930 70 MALÅ  
Sweden

<b>Content</b>	<b>Page</b>	<b>Content</b>	<b>Page</b>
<b>Product description</b> .....	4		
Transferpump main parts .....	4		
Relief valve .....	5		
<b>Upstart</b> .....	6		
Assemble the transferpump.....	6		
Bleeding the pump .....	8		
Installation of bucket adapter .....	9		
<b>Procedures</b> .....	10		
Refilling grease .....	10		

## Product description

### Transferpump main parts

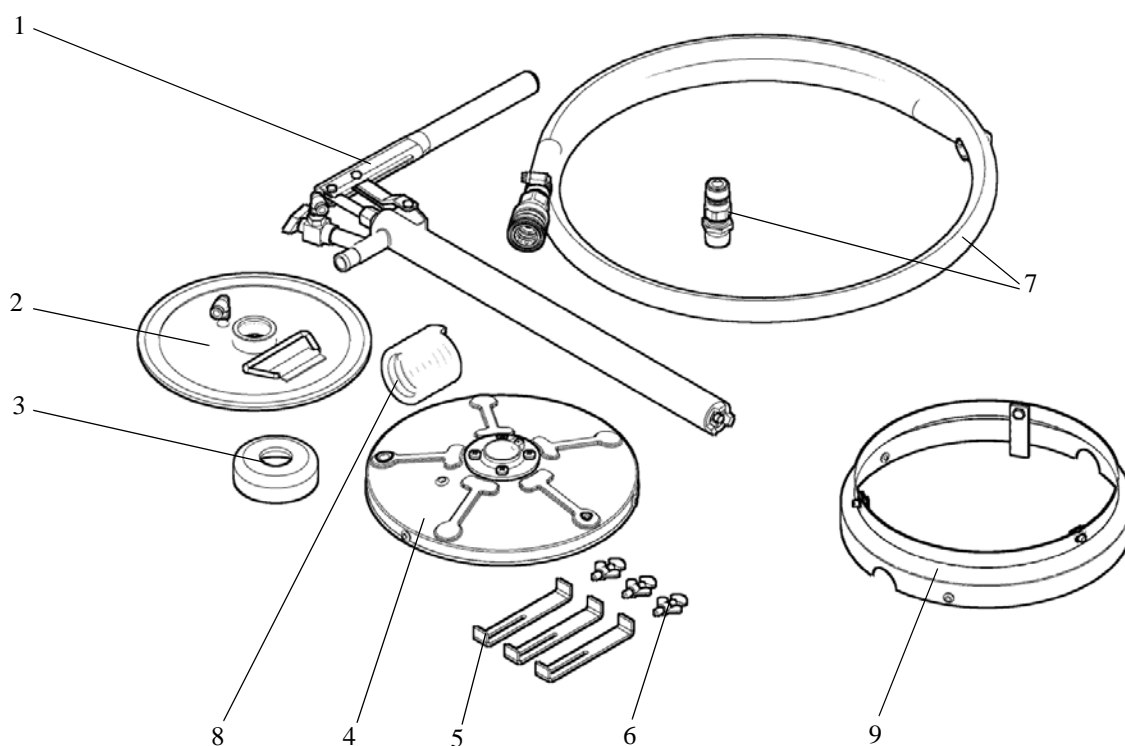

Fig. 1 Main parts

- 1 Pump
- 2 Follower plate with seal and pump-tube support
- 3 Dust seal
- 4 Lid
- 5 Hose brackets
- 6 Thumb screws with nuts
- 7 Hose with clamps and quick couplers
- 8 Grease return line hose
- 9 Adapter for 18 kg bucket

## Relief valve

When refilling grease, the quick couplers can get stuck to each other by the pressure built up in the hose. To avoid this problem, Hultdins transferpump is equipped with a relief valve. If the quick coupler should get stuck, the relief valve is opened and the hose is depressurized and then the quick coupler is easier to remove.

The excess grease is led from the relief valve, through the return line and back into the bucket

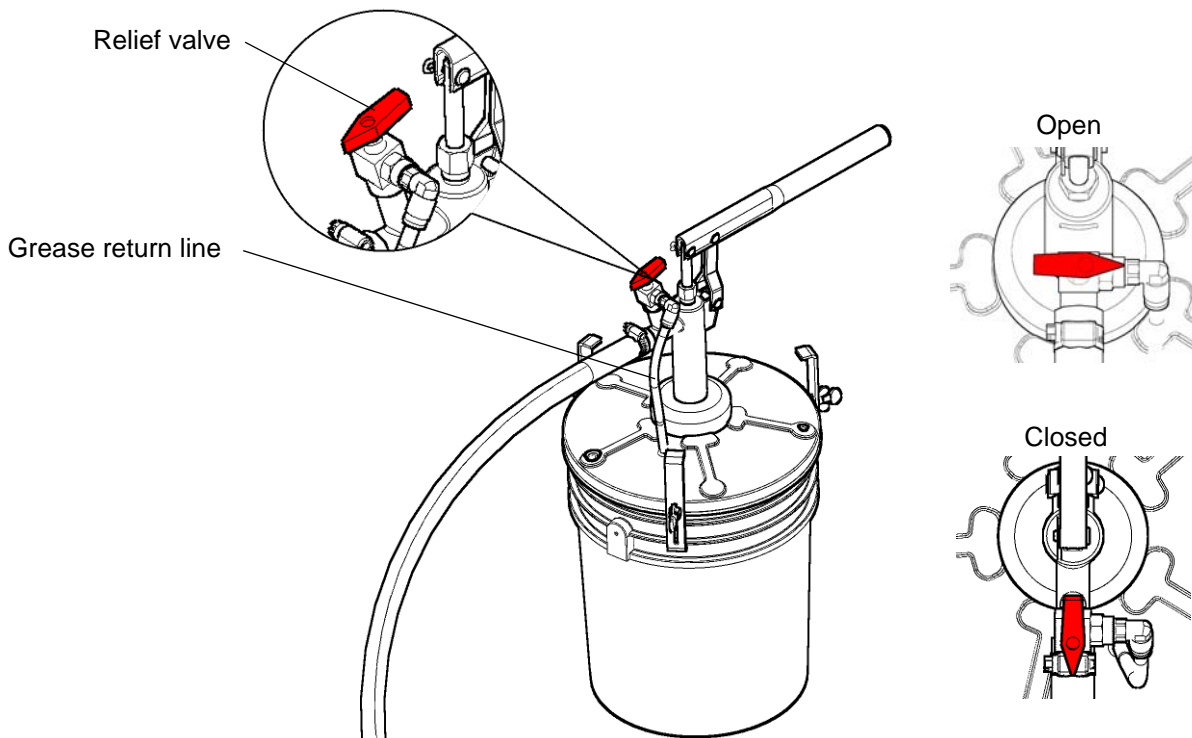

## Upstart

### Assemble the transferpump

1. Assemble the pump, lid, dust seal, return hose and the follower plate.

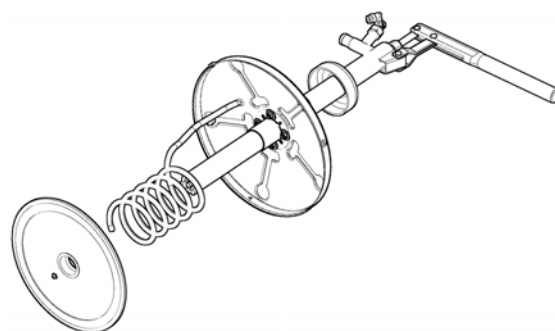

Fig. 1 Assemble the pump, dust seal and the follower plate

2. Install the return hose to the relief valve and to the follower plate by pushing the hose into the nipples.

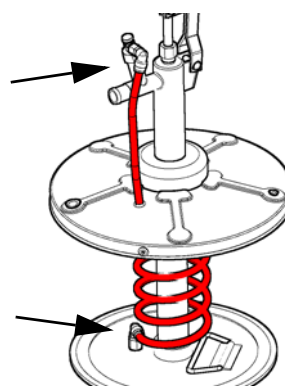

Fig. 2 Install the return hose

3. Press the follower plate into the grease barrel.

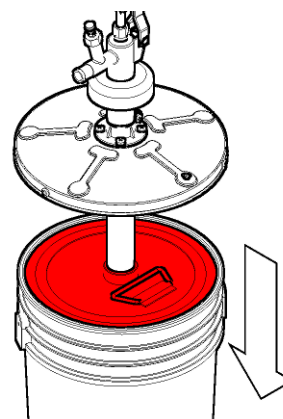

Fig. 3 Press the follower plate into the grease barrel

4. Install the pump and lid to the grease barrel

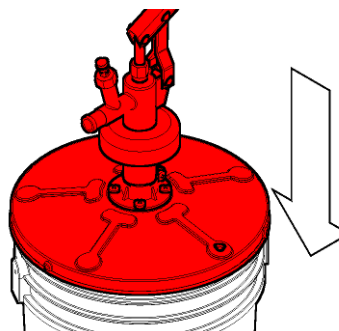

Fig. 4 Install the pump and lid to the grease barrel

5. Lock the lid in place with the three thumb screws. Adjust the hose brackets to the correct position and lock them with the nuts.

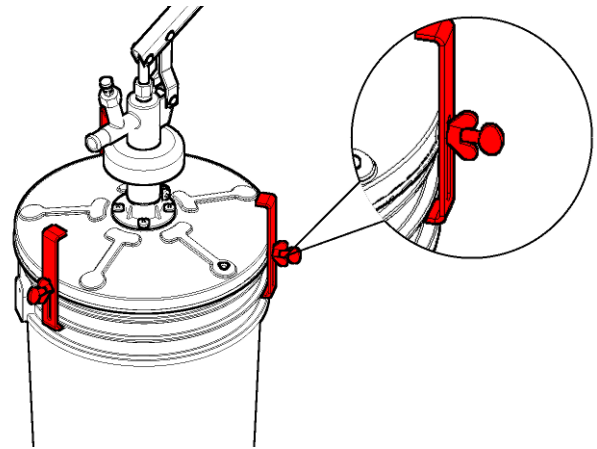

Fig. 5 Lock the lid in place

6. Lock the pump to the lid and lower the dust seal.

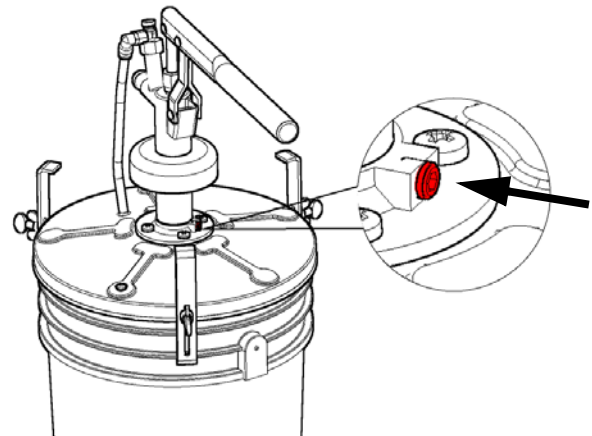

Fig. 6 Lock the pump to the lid

7. Install the hose to the pump and tighten the hose clamp.

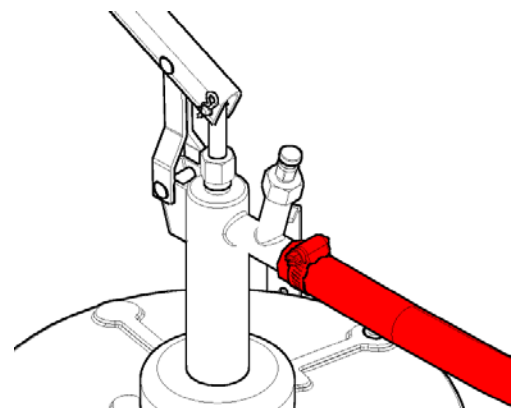

Fig. 7 Install the hose

## Bleeding the pump

1. Disconnect the lever from the pump rod.

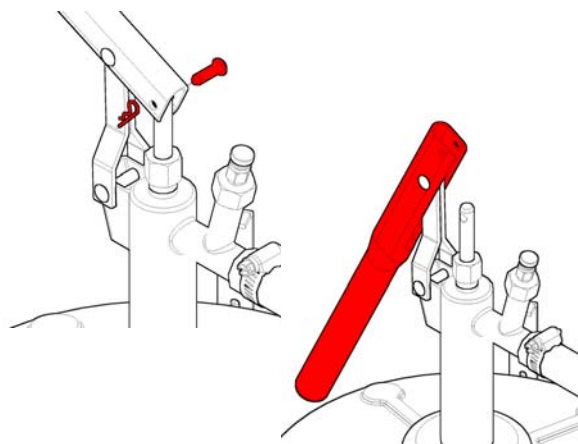

Fig. 8 Disconnect the lever from the pump rod

2. Use a screw driver as a handle and pump the rod all the way up and down 3- 4 times.

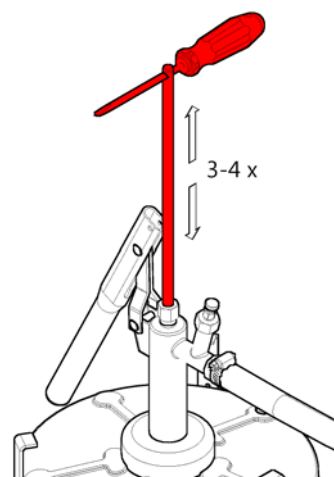

Fig. 9 Pump the rod 3 - 4 times

3. Reconnect the lever with the pump rod.

4. Install the quick coupler to the hose and tighten the clamp.

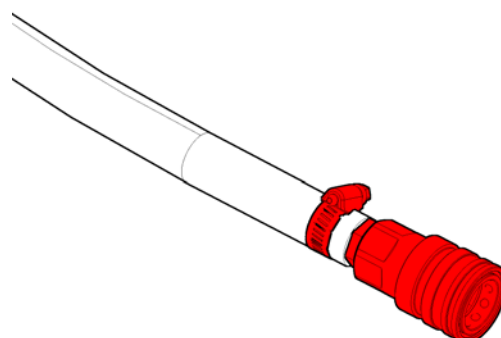

Fig. 10 Install the quick coupler



## Installation of bucket adapter

To make the Hultdins transfer pump fit an 18 kg grease bucket, an adapter has to be installed to the lid. To install the adapter, do as described below.

1. Place the adapter into the lid. Make sure that the oval holes in the adapter aligns with the threaded holes in the lid.

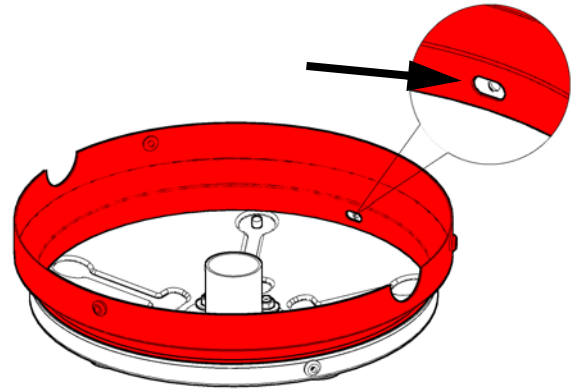

Fig. 1 Place the adapter into the lid

2. Assemble the adapter to the lid, using the guide brackets.

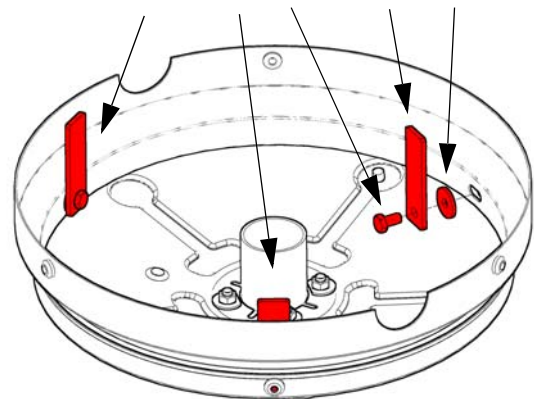

Fig. 2 Assemble the adapter to the lid

3. Properly assembled adapter

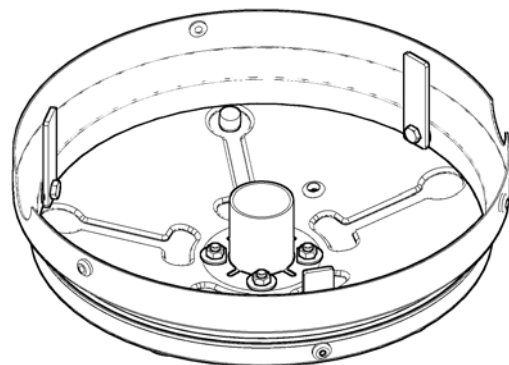

Fig. 3 Properly assembled adapter

## Procedures

### Refilling grease

1. Clean the quick couplers.  
**Note!** Always clean the quick coupler before refilling grease, to prevent any contamination to cause the chain grease pump to malfunction.
2. Connect the transfer pump to the chain grease pump using the quick couplers.
3. Pump grease with the barrel pump until the chain grease pump is full. This can be noticed as an increase in pumping resistance.

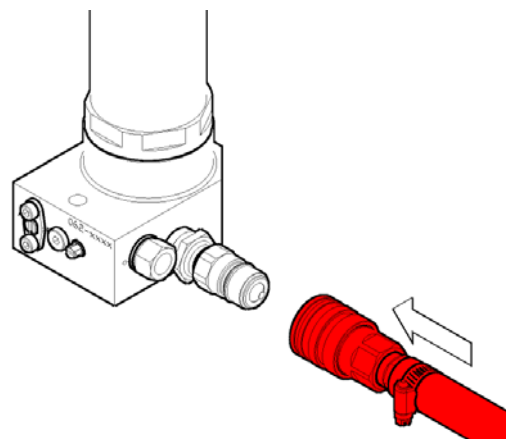

Fig. 4 Connect the transfer pump to the chain grtease pump

4. Depressurize the pump by opening the relief valve

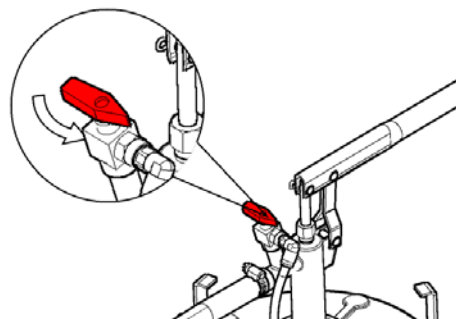

Fig. 5 Depressurize the pump

5. Disconnect the transfer pump and make sure that grease is not leaking backwards through the quick coupling.



**Caution!**

Use safety glasses and protective gloves when servicing the equipment. Hydraulic oil or lubricants in contact with skin or eyes may cause irritations or allergies.



Fig. 6 Use safety glasses and protective gloves



# **HULTDINS** **C**hain grease Pump

---

